

Beaumont

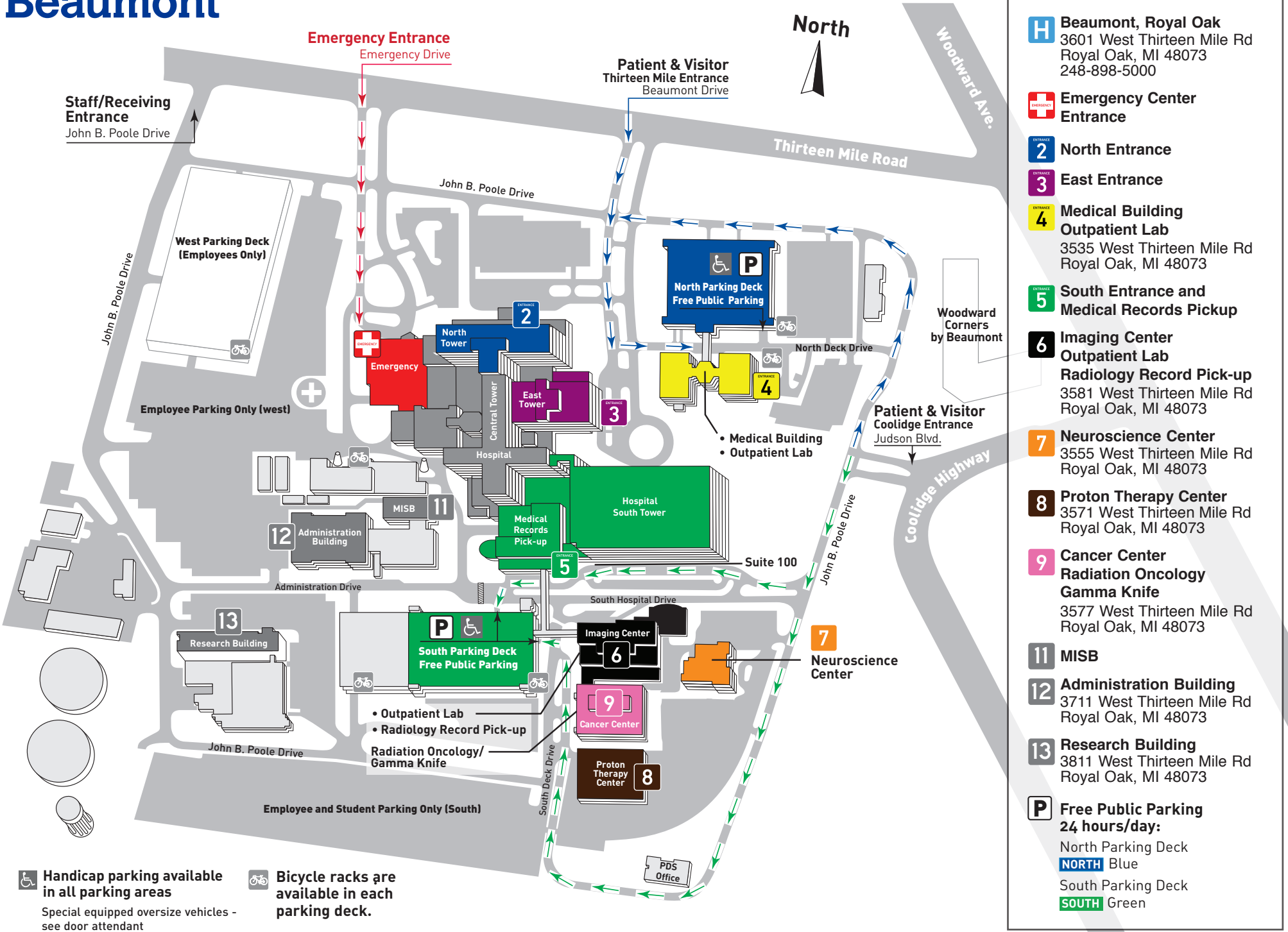

Beaumont Hospital, Royal Oak
Patient and Visitor Parking Information
(Information subject to change)

Hospital Parking

Free parking is available in the North (blue) Parking Deck and South (green) Parking Deck.

Valet Parking

Valet parking can be accessed at the North, South, East and the Cancer Center entrances for a fee.

The valet parking hours of service are:

North Entrance -

Monday through Friday – 5:30 a.m. to midnight

Weekends and holidays – 8 a.m. to midnight

East Entrance -

Monday through Friday – 5:30 a.m. to 9 p.m.

Cars can be retrieved from 9 – 11 p.m. at the South Entrance valet.

Weekends and holidays – Closed

South Entrance -

Monday through Friday – 5 a.m. to 11 p.m.

Weekends and holidays – 8 a.m. to 11 p.m.

Cancer Center -

Monday through Friday – 6 a.m. to 4:30 p.m.

Weekends and holidays – Closed

Emergency Entrance –

24 hours a day, seven days a week

All cars left in valet parking after closing can be retrieved by calling Security – 248-898-0911 or ext. 80911 using a Beaumont phone.

Day of discharge parking

Please speak to the patient's nurse on the day of discharge or refer to the discharge brochure in the patient's room to determine which entrance to use. Drive to that entrance and speak with the attendant, who will direct you either to the valet or free parking area.

Beaumont

Beaumont Hospital, Royal Oak
 3601 West 13 Mile Road
 Royal Oak, MI 48073

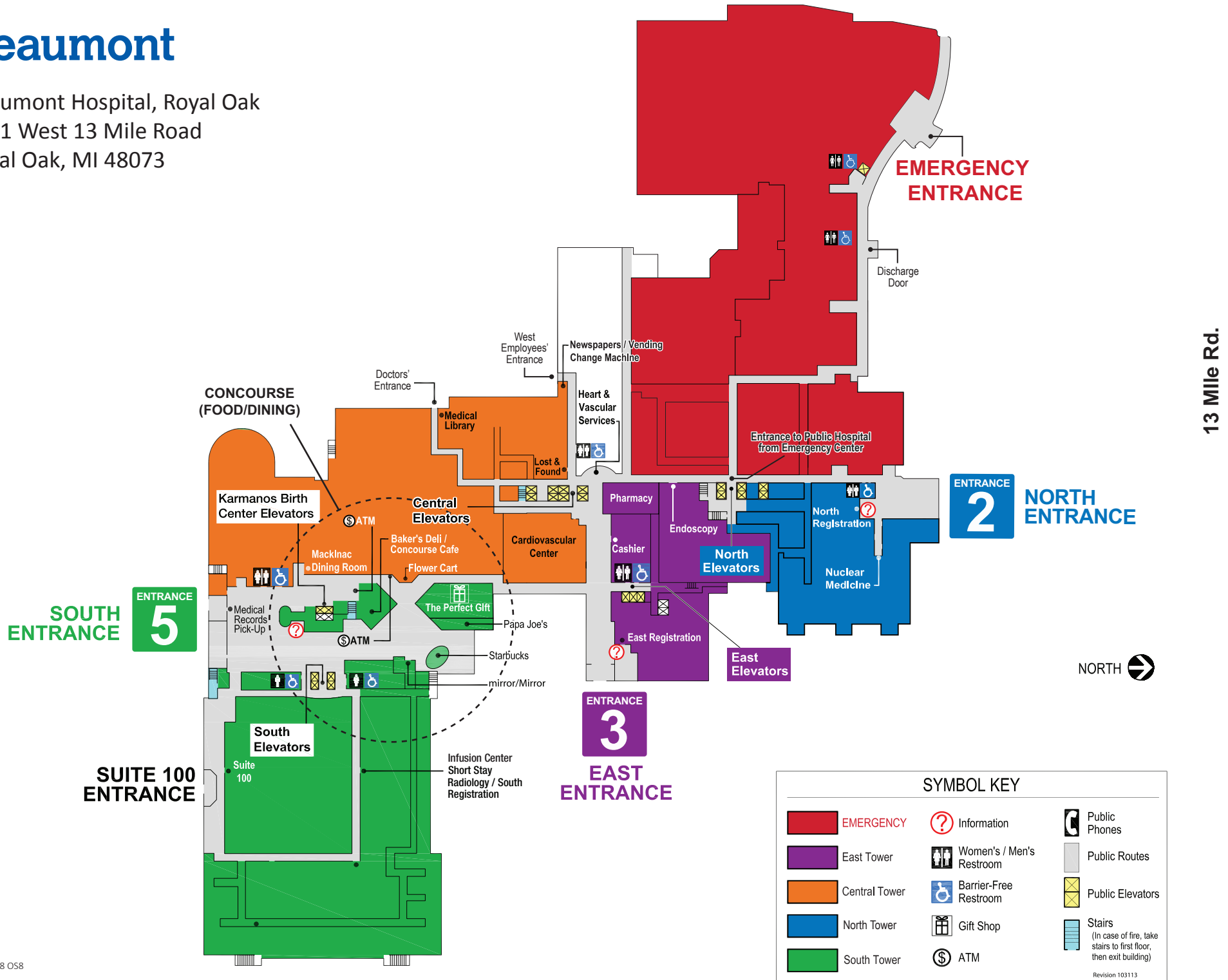

Dining



Whether you're looking for a quick bite to eat, a cup of coffee or someplace to relax and enjoy a full meal, Beaumont has several dining options:

Mackinac Dining Room – South Tower First Floor

Enjoy healthy, appetizing meals in the Mackinac Dining Room. In addition to bagels, soups, sandwiches, baked goods and more, you'll find daily specials, vegetarian selections and a fresh salad bar every day.

The Mackinac Dining Room is open 6:30 a.m. to 2:00 a.m. each day. Breakfast is served from 6:30 to 9:30 a.m.; lunch from 10:45 a.m. to 2:00 p.m. and dinner from 4:45 to 7:30 p.m.; midnight hot meal service from 11:00 p.m. to 2:00 a.m.

The Baker's Deli – South Tower Concourse

Stop by for freshly made soups, sandwiches, salads and baked goods at the Baker's Deli. For your convenience, you can pick up a gallon of milk or a loaf of bread before you head home, or select a delectable gourmet dessert to take home to your family.

The Baker's Deli is open Monday through Friday from 9:00 a.m. to 7:00 p.m.; Saturday and Sunday from 10:30 a.m. to 6:00 p.m. and holidays from 10:30 a.m. to 2:30 p.m.

The Concourse Café –

With a rotating menu featuring international cuisine, there's always something new at the Concourse Café with main entrees, side dishes and vegetarian selections.

The Concourse Café is open Monday through Friday from 10:30 a.m. to 7:00 p.m. and closed on Saturday, Sunday and Holidays.

Starbucks –

If you need a little pick-me-up, visit Starbucks at the far north end of the South Tower Concourse. Beaumont's full-service Starbucks features all of your favorite coffee creations as well as a selection of baked goods and coffee beans to take home with you.

Starbucks is open Monday through Friday from 5:30 a.m. to 9:00 p.m.; Saturday and Sunday 5:30 a.m. to 7:00 p.m. and closed on holidays.

Papa Joe's Market – Features a variety of fresh fruit, homemade soups and fresh baked goods. It includes fresh Mediterranean foods as well as sushi made to order. Come and visit our gourmet food case that changes daily.

Monday through Friday 6:30 a.m. to 9:00 p.m.; Saturday and Sunday 9:00 a.m. to 7:00 p.m.

The Coffee Shop – Medical Office Building, First Floor

If you're looking for a quick bite to eat or a cup of coffee to get you going, stop by The Coffee Shop on the first floor of the Medical Office Building. There you'll find a selection of sandwiches, soups and snacks as well as coffee and other beverages.

The Coffee Shop is open Monday through Friday from 7:15 a.m. to 2:45 p.m.

Shopping



Looking for a card, a gift or flowers for someone special? Walk through the South Tower Concourse and enjoy a wide variety of shopping opportunities.

The Perfect Gift – Features everything from books, magazines and cards to gift items, jewelry and more.

It's open Monday through Friday 8:00 a.m. to 7:00 p.m., Saturday and Sunday from 10:00 a.m. to 6:00 p.m. and holidays from 10:00 a.m. to 3:00 p.m.

mirror Mirror Boutique – A women's & men's boutique featuring the most unique and affordable apparel and accessories in the area.

Mirror Mirror is open Monday through Friday 9:00 a.m. to 5:00 p.m., Saturday 10:00 a.m. to 6:00 p.m.; Closed on Sundays.

The Flower Cart – Features a fresh supply of beautiful floral arrangements, plants, baskets and gifts.

The Flower Cart is open Monday through Friday 9:00 a.m. to 5:00 p.m., Saturday and Sunday from 10:00 a.m. to 6:00 p.m. and on holidays from 10:00 a.m. to 3:00 p.m.

Looking for a place to relax?



Enjoy the tranquility and beauty of the **Debra Saber Salisbury Memorial Garden on 6 South.**

The indoor garden is lit by natural sunlight from the atrium during the day; in the evening, artificial lighting replicates moonlight. You can access the Memorial Garden by taking the South Public Elevators (brass-colored elevators) to 6 South. The Memorial Garden is open from 8:00 a.m. to 8:00 p.m.

Automated Teller Machines

are available in the South Tower, Employee Services Centers, Central Tower, Administration Building, Lower Level Tunnel, first floor Medical Office Building and the Cancer Center.

Beaumont

Beaumont Hospital, Royal Oak
 3601 West 13 Mile Road
 Royal Oak, MI 48073

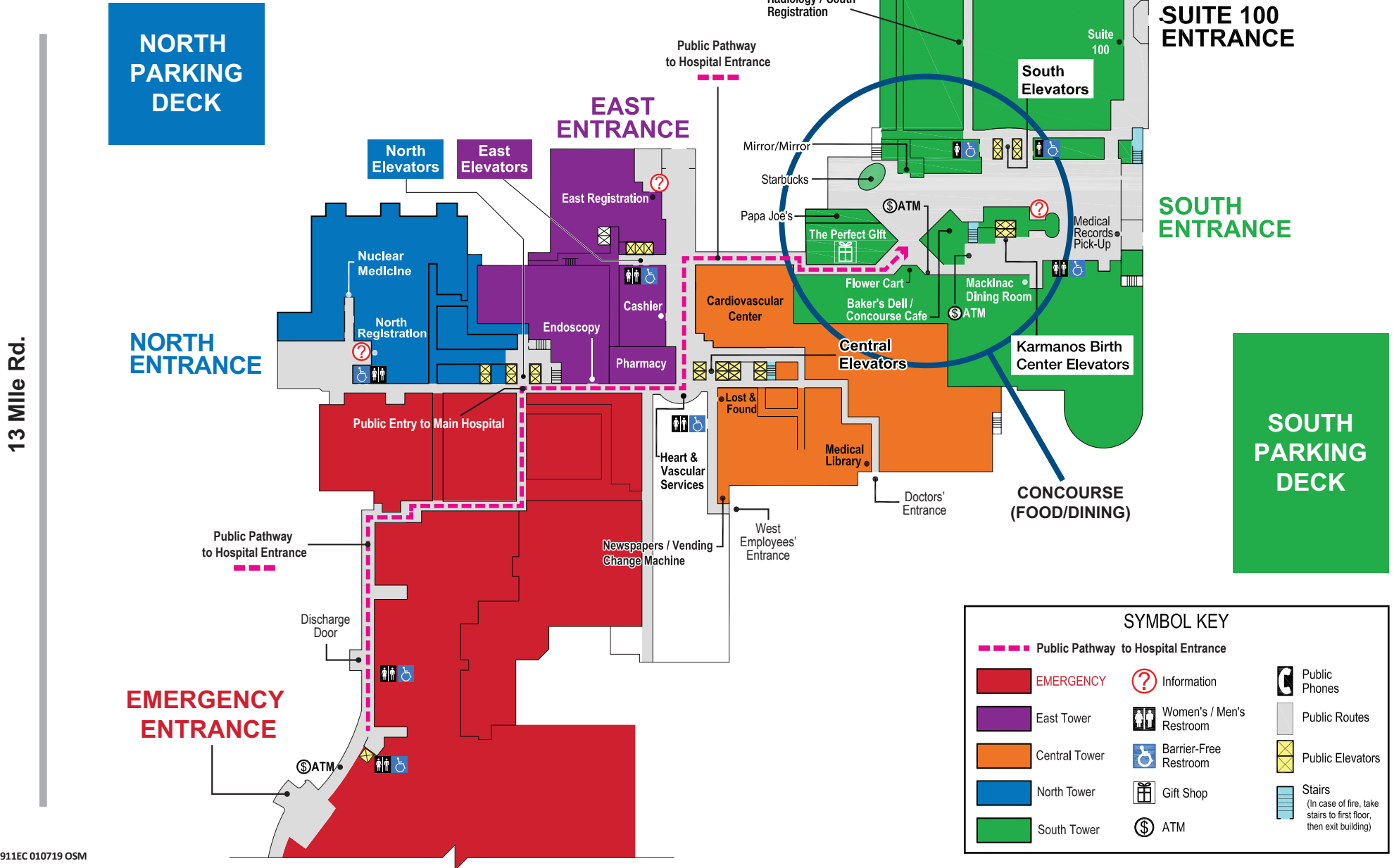

**NORTH
 PARKING
 DECK**

**SUITE 100
 ENTRANCE**

**SOUTH
 ENTRANCE**

**SOUTH
 PARKING
 DECK**

**NORTH
 ENTRANCE**

**EMERGENCY
 ENTRANCE**

**CONCOURSE
 (FOOD/DINING)**

SYMBOL KEY

	Public Pathway to Hospital Entrance		Information		Public Phones
	EMERGENCY		Women's / Men's Restroom		Public Routes
	East Tower		Barrier-Free Restroom		Public Elevators
	Central Tower		Gift Shop		Stairs (In case of fire, take stairs to first floor, then exit building)
	North Tower		ATM		
	South Tower				

Beaumont CHILDREN'S

Emergency Entrance
Emergency Drive

**Patient & Visitor
Thirteen Mile Entrance**
Beaumont Drive

Beaumont Hospital, Royal Oak
3601 W. Thirteen Mile Road
Royal Oak, MI 48073-9769
248-898-5000

Imaging Center
3581 W. Thirteen Mile Road
Royal Oak, MI 48073-9769

Medical Office Building
3535 W. Thirteen Mile Road
Royal Oak, MI 48073-6769

Cancer Center
3577 W. Thirteen Mile Road
Royal Oak, MI 48073-9769

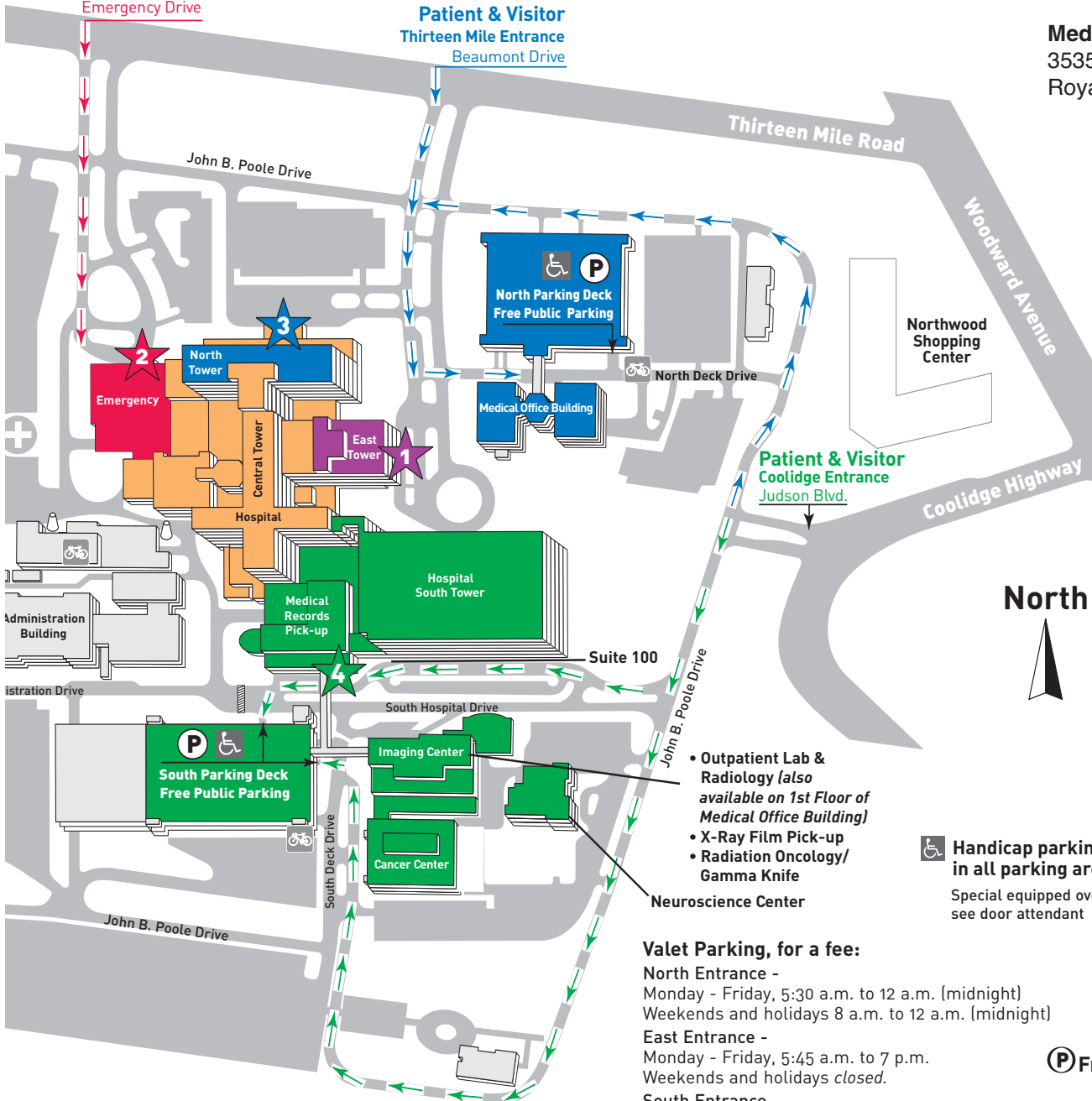

Cancer Center

Pediatric Hematology/Oncology Clinic

Central Tower

Ghesqiere Family Center for Children's Surgery

North Tower

Emergency Center

South Tower

General Pediatrics Unit
Pediatric Intensive Care Unit
Neonatal Intensive Care Unit
Pediatric Procedure Suite
Pediatric Radiology

Medical Office Building

General Pediatric Outpatient Clinic
Pediatric After Hours Clinic
Pediatric Surgery Clinic
Pediatric Subspecialty Clinics
Pediatric Neurology
Pediatric Lab/Blood Draw

North



- East Entrance
- Emergency Center Entrance
- North Entrance
- South Entrance and Medical Records Pick-up



Handicap parking available in all parking areas.

Special equipped oversize vehicles - see door attendant

- Outpatient Lab & Radiology (also available on 1st Floor of Medical Office Building)
- X-Ray Film Pick-up
- Radiation Oncology/ Gamma Knife

Neuroscience Center

Valet Parking, for a fee:

North Entrance -
Monday - Friday, 5:30 a.m. to 12 a.m. (midnight)
Weekends and holidays 8 a.m. to 12 a.m. (midnight)

East Entrance -
Monday - Friday, 5:45 a.m. to 7 p.m.
Weekends and holidays closed.

South Entrance -
Monday - Friday, 5:30 a.m. to 11 p.m.
Weekends and holidays 8 a.m. to 11 p.m.

Emergency Entrance -
10:00 a.m. to 12 a.m. (midnight) daily

Free Public Parking 24 hours/day:

North Parking Deck **NORTH** Blue

South Parking Deck **SOUTH** Green



Bicycle racks are available in each parking deck.

Beaumont is a smoke-free campus

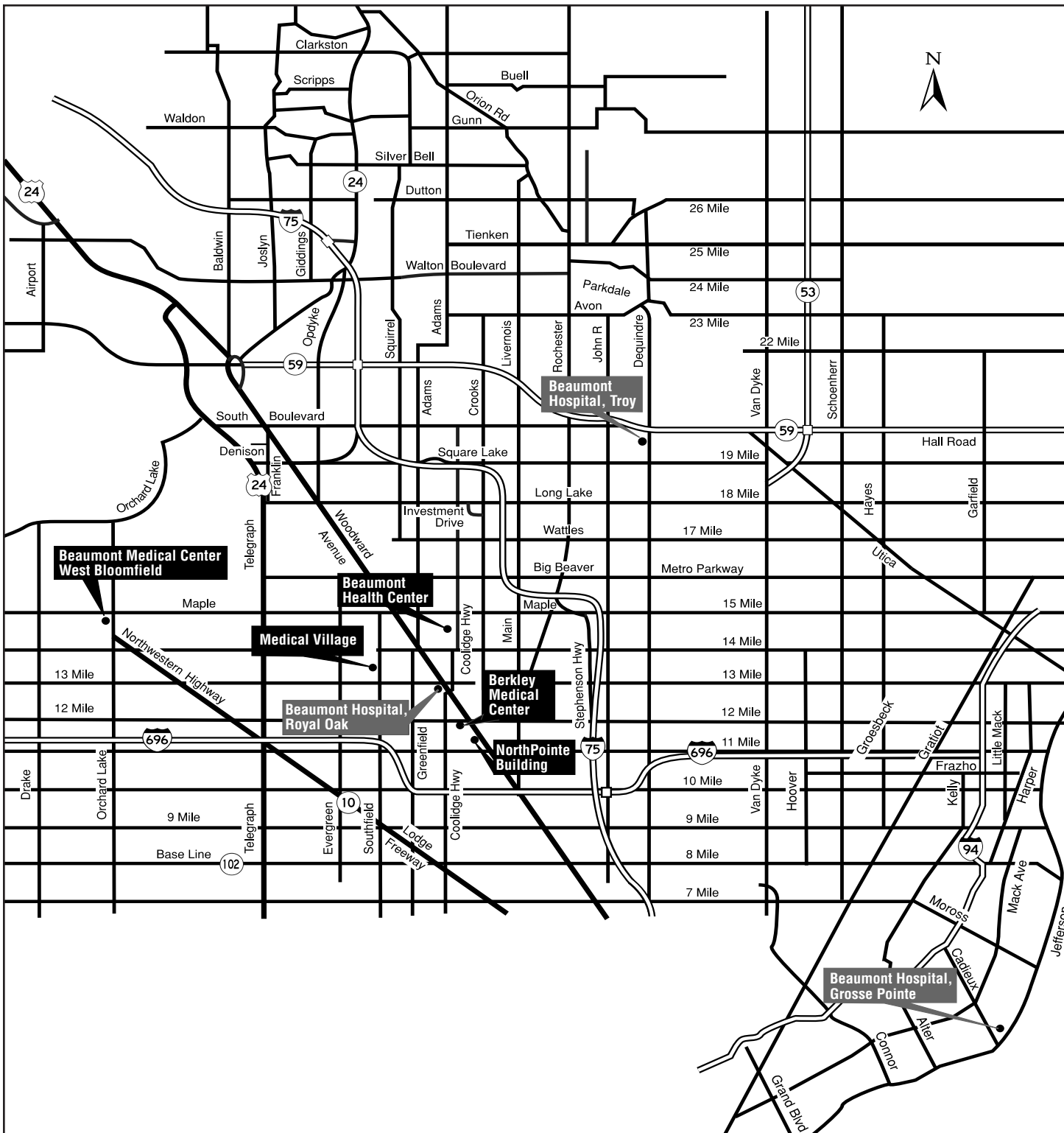

Beaumont Children's Hospital Locations

Beaumont Troy Hospital

44201 Dequindre Road
Troy, MI 48085-1198
248-964-5000

- ▶ General Unit
- ▶ After Hours Clinic
- ▶ Emergency Center

Beaumont Grosse Pointe

468 Cadieux Road
Grosse Pointe, MI 48230
313-343-1000

- ▶ General Pediatrics Unit

Berkley Medical Center

1695 West 12 Mile Road
Berkley, MI 48072
248-691-4744

- ▶ Center for Human Development

Beaumont Health Center

4949 Coolidge Hwy.
Royal Oak, MI 48073-6769
248-655-5695

- ▶ Pediatric Speech Pathology
- ▶ Pediatric Rehabilitation

Beaumont West Bloomfield

6900 Orchard Lake Road, Ste. 114
West Bloomfield, MI 48322
248-855-7435

- ▶ Pediatric Speech Pathology
- ▶ Pediatric Rehabilitation

Medical Village

31815 Southfield, Ste. 22
Beverly Hills, MI 48024
248-594-3142

- ▶ Adolescent Medicine Center

NorthPointe Building

1949 West 12 Mile Road LL
Berkley, MI 48072
248-547-4276

- ▶ Sleep Center

Beaumont

CANCER, IMAGING, NEUROSCIENCE AND PROTON CENTERS

ROYAL OAK

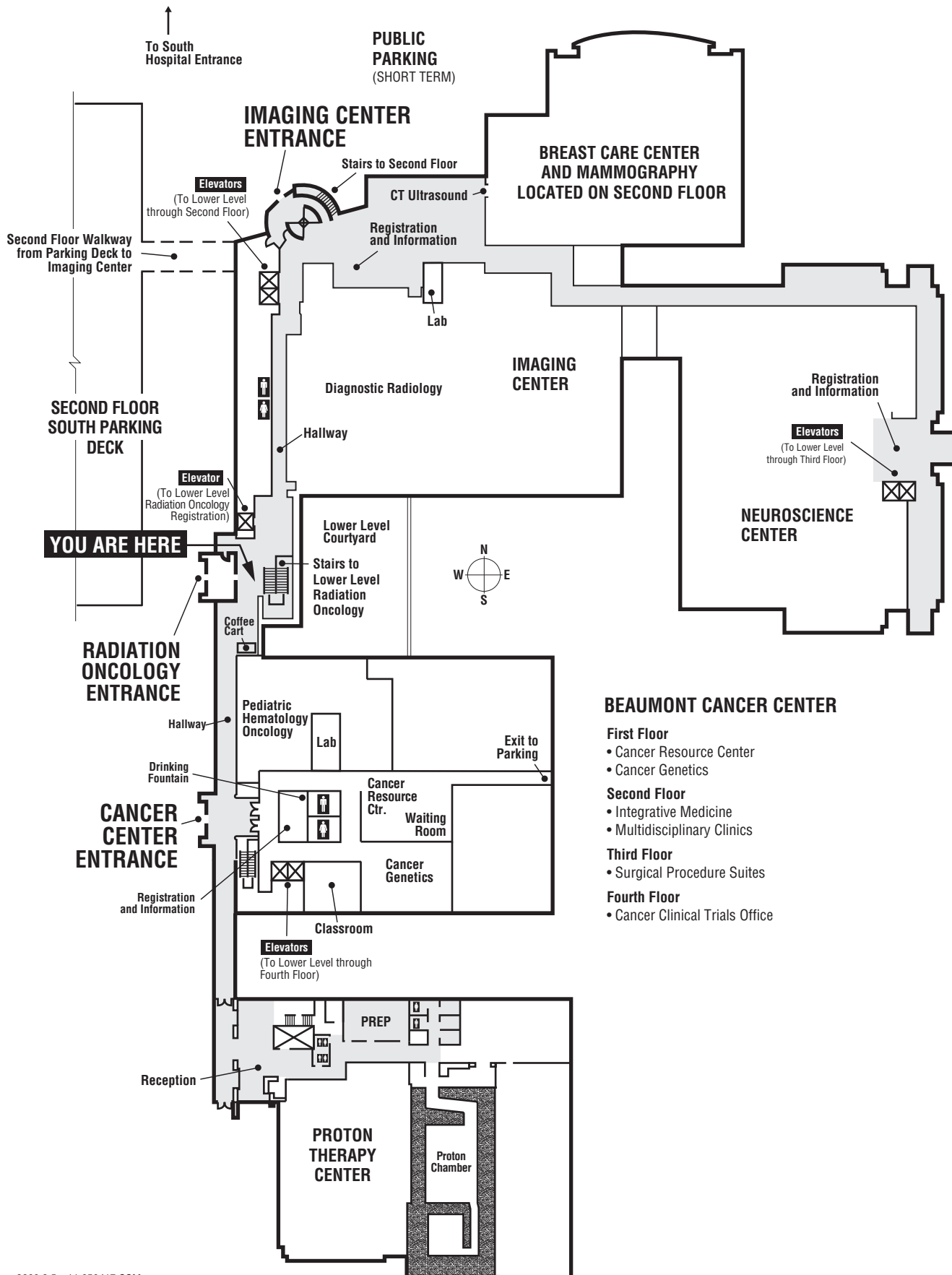

BEAUMONT CANCER CENTER

First Floor

- Cancer Resource Center
- Cancer Genetics

Second Floor

- Integrative Medicine
- Multidisciplinary Clinics

Third Floor

- Surgical Procedure Suites

Fourth Floor

- Cancer Clinical Trials Office